

CLA

Union Elbow Fittings

Hy-Lok



CLA Union Elbow Fittings



All dimensions are in millimeters unless otherwise specified. Dimensions are for reference only, subject to change.

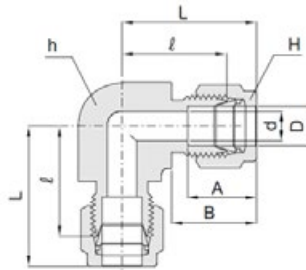

Connects Fractional Tubes

PartNo.	Tube OD		d. Min	Width across flat (in.)		A	B	L	L
	In.	mm		h	H				
CLA-1	1/16	1.58	1.3	3/8	5/16	8.6	10.9	14.0	17.9
CLA-2	1/8	3.17	2.3	3/8	7/16	12.7	15.2	15.7	22.4
CLA-3	3/16	4.76	3.0	1/2	1/2	13.7	16.0	17.8	24.4
CLA-4	1/4	6.35	4.8	1/2	9/16	15.2	17.8	19.6	26.9
CLA-5	5/16	7.93	6.3	9/16	5/8	16.3	18.5	21.3	28.7
CLA-6	3/8	9.52	7.0	5/8	11/16	16.8	19.3	23.1	30.5
CLA-8	1/2	12.70	10.4	13/16	7/8	22.9	21.8	25.9	36.1
CLA-10	5/8	15.87	12.7	15/16	1	24.4	21.8	28.7	38.8
CLA-12	3/4	19.05	15.7	1-1/16	1-1/8	24.4	21.8	29.7	39.9
CLA-14	7/8	22.22	18.3	1-3/16	1-1/4	25.9	21.8	34.5	44.7
CLA-16	1	25.40	22.3	1-3/8	1-1/2	31.2	26.4	36.8	49.0
CLA-20	1-1/4	31.75	28.0	1-11/16	1-7/8	41.1	38.9	44.5	66.5
CLA-24	1-1/2	38.10	34.0	2	2-1/4	50.0	45.2	50.8	78.0
CLA-32	2	50.80	46.0	2-3/4	3	67.6	62.7	69.8	107.2

Connects Metric Tubes

PartNo.	Tube OD D	d. Min	Width across flat (in.)		A	B	L	L
			h	H				
CLA-2M	2	1.7	3/8	12	12.9	15.3	15.7	22.3
CLA-3M	3	2.3	3/8	12	12.9	15.3	15.7	22.3
CLA-4M	4	2.4	1/2	12	13.7	16.4	18.8	25.4
CLA-6M	6	4.8	1/2	14	15.3	17.7	19.6	27.0
CLA-8M	8	6.3	9/16	16	16.2	18.6	21.3	28.8
CLA-10M	10	8.0	11/16	19	17.2	19.5	23.9	31.5
CLA-12M	12	9.5	13/16	22	22.8	22.0	25.9	36.0
CLA-15M	15	12.0	15/16	25	24.4	22.0	28.7	38.8
CLA-16M	16	12.7	15/16	25	24.4	22.0	28.7	38.8
CLA-18M	18	15.0	1-1/16	30	24.4	22.0	29.7	39.8
CLA-20M	20	16.0	30mm	32	26.0	22.0	32.5	44.6
CLA-22M	22	18.3	30mm	32	26.0	22.0	32.5	44.6
CLA-25M	25	22.0	1-3/8	38	31.3	26.5	36.8	49.1
CLA-28M	28	23.0	41mm	46	36.6	36.6	43.2	64.0
CLA-32M	32	28.0	46mm	50	42.0	41.6	49.3	72.3
CLA-38M	38	34.0	55mm	60	49.4	47.9	56.4	84.0
CLA-42M	42	36.0	55mm	65	55.1	53.6	58.0	89.1
CLA-50M	50	45.2	70mm	3 in.	65.0	61.0	69.0	106.0