

CUR

Reducing Union Fittings

Hy-Lok

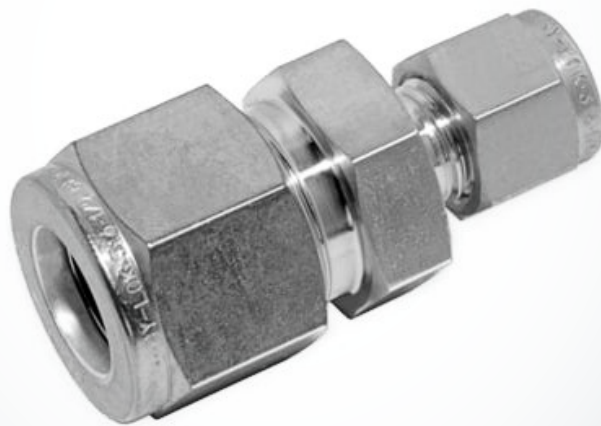

CUR Reducing Union Fittings

All dimensions are in millimeters unless otherwise specified.
Dimensions are for reference only, subject to change.

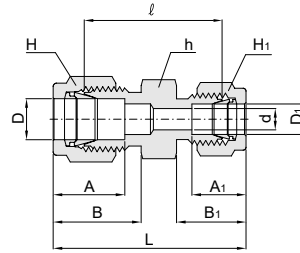

Connects Fractional Tubes

| Part No. | Tube OD | | Tube OD | | d. Min | Width across flat (in.) | | | A | A' | B | B' | L | L |
|----------|---------|-------|---------|-------|--------|-------------------------|-------|-------|------|------|------|------|------|------|
| | D | | D' | | | h | H | H' | | | | | | |
| | In. | mm | In. | mm | | | | | | | | | | |
| CUR2-1 | 1/8 | 3.17 | 1/16 | 1.58 | 1.3 | 7/16 | 7/16 | 5/16 | 12.7 | 8.6 | 15.2 | 10.9 | 20.6 | 30.9 |
| CUR3-1 | 3/16 | 4.76 | 1/16 | 1.58 | 1.3 | 7/16 | 1/2 | 5/16 | 13.7 | 8.6 | 16.0 | 10.9 | 21.8 | 32.3 |
| CUR3-2 | 3/16 | 4.76 | 1/8 | 3.17 | 2.3 | 7/16 | 1/2 | 7/16 | 13.7 | 12.7 | 16.0 | 15.2 | 23.4 | 36.6 |
| CUR4-1 | 1/4 | 6.35 | 1/16 | 1.58 | 1.3 | 1/2 | 9/16 | 5/16 | 15.2 | 8.6 | 17.8 | 10.9 | 23.1 | 34.3 |
| CUR4-2 | 1/4 | 6.35 | 1/8 | 3.17 | 2.3 | 1/2 | 9/16 | 7/16 | 15.2 | 12.7 | 17.8 | 15.2 | 24.6 | 38.6 |
| CUR4-3 | 1/4 | 6.35 | 3/16 | 4.76 | 3.0 | 1/2 | 9/16 | 1/2 | 15.2 | 13.7 | 17.8 | 16.0 | 25.4 | 39.4 |
| CUR5-2 | 5/16 | 7.93 | 1/8 | 3.17 | 2.3 | 9/16 | 5/8 | 7/16 | 16.3 | 12.7 | 18.5 | 15.2 | 25.9 | 39.9 |
| CUR5-4 | 5/16 | 7.93 | 1/4 | 6.35 | 4.8 | 9/16 | 5/8 | 9/16 | 16.3 | 15.2 | 18.5 | 17.8 | 24.7 | 42.2 |
| CUR6-1 | 3/8 | 9.52 | 1/16 | 1.58 | 1.3 | 5/8 | 11/16 | 5/16 | 16.8 | 8.6 | 19.3 | 10.9 | 25.4 | 36.6 |
| CUR6-2 | 3/8 | 9.52 | 1/8 | 3.17 | 2.3 | 5/8 | 11/16 | 7/16 | 16.8 | 12.7 | 19.3 | 15.2 | 26.9 | 40.9 |
| CUR6-4 | 3/8 | 9.52 | 1/4 | 6.35 | 4.8 | 5/8 | 11/16 | 9/16 | 16.8 | 15.2 | 19.3 | 17.8 | 28.4 | 43.2 |
| CUR6-5 | 3/8 | 9.52 | 5/16 | 7.93 | 6.3 | 5/8 | 11/16 | 5/8 | 16.8 | 16.3 | 19.3 | 18.5 | 29.5 | 44.2 |
| CUR8-2 | 1/2 | 12.70 | 1/8 | 3.17 | 2.3 | 13/16 | 7/8 | 7/16 | 22.9 | 12.7 | 21.8 | 15.2 | 28.4 | 45.2 |
| CUR8-4 | 1/2 | 12.70 | 1/4 | 6.35 | 4.8 | 13/16 | 7/8 | 9/16 | 22.9 | 15.2 | 21.8 | 17.8 | 29.5 | 47.0 |
| CUR8-6 | 1/2 | 12.70 | 3/8 | 9.52 | 7.0 | 13/16 | 7/8 | 11/16 | 22.9 | 16.8 | 21.8 | 19.3 | 31.0 | 48.5 |
| CUR10-6 | 5/8 | 15.87 | 3/8 | 9.52 | 7.0 | 15/16 | 1 | 11/16 | 24.4 | 16.8 | 21.8 | 19.3 | 31.8 | 49.3 |
| CUR10-8 | 5/8 | 15.87 | 1/2 | 12.70 | 10.4 | 15/16 | 1 | 7/8 | 24.4 | 22.9 | 21.8 | 21.8 | 31.8 | 52.1 |
| CUR12-4 | 3/4 | 19.05 | 1/4 | 6.35 | 4.8 | 1-1/16 | 1-1/8 | 9/16 | 24.4 | 15.2 | 21.8 | 17.8 | 31.8 | 49.3 |
| CUR12-6 | 3/4 | 19.05 | 3/8 | 9.52 | 7.0 | 1-1/16 | 1-1/8 | 11/16 | 24.4 | 16.8 | 21.8 | 19.3 | 33.3 | 50.8 |
| CUR12-8 | 3/4 | 19.05 | 1/2 | 12.70 | 10.4 | 1-1/16 | 1-1/8 | 7/8 | 24.4 | 22.9 | 21.8 | 21.8 | 33.3 | 53.6 |
| CUR12-10 | 3/4 | 19.05 | 5/8 | 15.87 | 12.7 | 1-1/16 | 1-1/8 | 1 | 24.4 | 24.4 | 21.8 | 21.8 | 33.3 | 53.6 |
| CUR16-8 | 1 | 25.40 | 1/2 | 12.70 | 10.4 | 1-3/8 | 1-1/2 | 7/8 | 31.2 | 22.9 | 26.4 | 21.8 | 40.9 | 63.2 |
| CUR16-12 | 1 | 25.40 | 3/4 | 19.05 | 15.7 | 1-3/8 | 1-1/2 | 1-1/8 | 31.2 | 24.4 | 26.4 | 21.8 | 40.4 | 62.7 |

CUR Reducing Union Fittings

All dimensions are in millimeters unless otherwise specified. Dimensions are for reference only, subject to change.

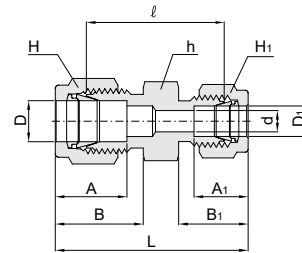

Connects Metric Tubes

| PartNo. | Tube OD | | d. Min | Width across flat (in.) | | | A | A' | B | B' | L | L' |
|------------|---------|----|--------|-------------------------|----|----|------|------|------|------|------|------|
| | D | | | h | H | H' | | | | | | |
| | In. | mm | | | | | | | | | | |
| CUR3M-2M | 3 | 2 | 1.7 | 7/16 in. | 12 | 12 | 12.9 | 12.9 | 15.3 | 15.3 | 22.1 | 35.3 |
| CUR6M-2M | 6 | 2 | 1.7 | 7/16 in. | 14 | 12 | 15.3 | 12.9 | 17.7 | 15.3 | 24.6 | 38.6 |
| CUR6M-3M | 6 | 3 | 2.3 | 1/2 in. | 14 | 12 | 15.3 | 12.9 | 17.7 | 15.3 | 24.6 | 38.6 |
| CUR6M-4M | 6 | 4 | 2.4 | 1/2 in. | 14 | 12 | 15.3 | 13.7 | 17.7 | 16.1 | 25.4 | 39.4 |
| CUR8M-6M | 8 | 6 | 4.8 | 14 | 16 | 14 | 16.2 | 15.3 | 18.6 | 17.7 | 27.4 | 42.3 |
| CUR10M-6M | 10 | 6 | 4.8 | 17 | 19 | 14 | 17.2 | 15.3 | 19.5 | 17.7 | 29.5 | 44.5 |
| CUR10M-8M | 10 | 8 | 6.3 | 17 | 19 | 16 | 17.2 | 16.2 | 19.5 | 18.6 | 30.0 | 45.1 |
| CUR12M-6M | 12 | 6 | 4.8 | 13/16 in. | 22 | 14 | 22.8 | 15.3 | 22.0 | 17.7 | 29.5 | 47.0 |
| CUR12M-8M | 12 | 8 | 6.3 | 13/16 in. | 22 | 16 | 22.8 | 16.2 | 22.0 | 18.6 | 30.2 | 47.8 |
| CUR12M-10M | 12 | 10 | 8.0 | 13/16 in. | 22 | 19 | 22.8 | 17.2 | 22.0 | 19.5 | 31.0 | 48.7 |
| CUR16M-10M | 16 | 10 | 8.0 | 24 | 25 | 19 | 24.4 | 17.2 | 22.0 | 19.5 | 31.8 | 49.5 |
| CUR16M-12M | 16 | 12 | 9.5 | 24 | 25 | 22 | 24.4 | 22.8 | 22.0 | 22.0 | 31.8 | 52.0 |
| CUR18M-12M | 18 | 12 | 9.5 | 27 | 30 | 22 | 24.4 | 22.8 | 22.0 | 22.0 | 33.3 | 53.5 |
| CUR25M-18M | 25 | 18 | 15.0 | 35 | 38 | 30 | 31.3 | 24.4 | 26.5 | 22.0 | 38.6 | 61.0 |
| CUR25M-20M | 25 | 20 | 16.0 | 35 | 38 | 32 | 31.3 | 26.0 | 26.5 | 22.0 | 39.9 | 62.3 |