

# CTA

## Union Tee Fittings

**Hy-Lok**



# CTA Union Tee Fittings

All dimensions are in millimeters unless otherwise specified.  
Dimensions are for reference only, subject to change.

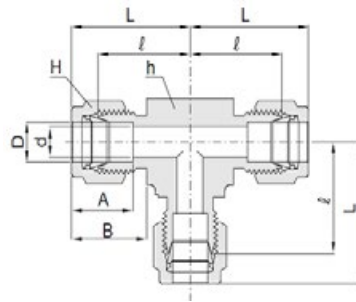

## Connects Fractional Tubes

PartNo.	Tube OD		d. Min	Width across flat (in.)		A	B	L	L
	In.	mm		h	H				
CLA-1	1/16	1.58	1.3	3/8	5/16	8.6	10.9	14.0	17.9
CLA-2	1/8	3.17	2.3	3/8	7/16	12.7	15.2	15.7	22.4
CLA-3	3/16	4.76	3.0	1/2	1/2	13.7	16.0	17.8	24.4
CLA-4	1/4	6.35	4.8	1/2	9/16	15.2	17.8	19.6	26.9
CLA-5	5/16	7.93	6.3	9/16	5/8	16.3	18.5	21.3	28.7
CLA-6	3/8	9.52	7.0	5/8	11/16	16.8	19.3	23.1	30.5
CLA-8	1/2	12.70	10.4	13/16	7/8	22.9	21.8	25.9	36.1
CLA-10	5/8	15.87	12.7	15/16	1	24.4	21.8	28.7	38.8
CLA-12	3/4	19.05	15.7	1-1/16	1-1/8	24.4	21.8	29.7	39.9
CLA-14	7/8	22.22	18.3	1-3/16	1-1/4	25.9	21.8	34.5	44.7
CLA-16	1	25.40	22.3	1-3/8	1-1/2	31.2	26.4	36.8	49.0
CLA-20	1-1/4	31.75	28.0	1-11/16	1-7/8	41.1	38.9	44.5	66.5
CLA-24	1-1/2	38.10	34.0	2	2-1/4	50.0	45.2	50.8	78.0
CLA-32	2	50.80	46.0	2-3/4	3	67.6	62.7	69.8	107.2

## Connects Metric Tubes

PartNo.	Tube OD D	d. Min	Width across flat (in.)		A	B	L	L
			h	H				
CLA-2M	2	1.7	3/8	12	12.9	15.3	15.7	22.3
CLA-3M	3	2.3	3/8	12	12.9	15.3	15.7	22.3
CLA-4M	4	2.4	1/2	12	13.7	16.4	18.8	25.4
CLA-6M	6	4.8	1/2	14	15.3	17.7	19.6	27.0
CLA-8M	8	6.3	9/16	16	16.2	18.6	21.3	28.8
CLA-10M	10	8.0	11/16	19	17.2	19.5	23.9	31.5
CLA-12M	12	9.5	13/16	22	22.8	22.0	25.9	36.0
CLA-15M	15	12.0	15/16	25	24.4	22.0	28.7	38.8
CLA-16M	16	12.7	15/16	25	24.4	22.0	28.7	38.8
CLA-18M	18	15.0	1-1/16	30	24.4	22.0	29.7	39.8
CLA-20M	20	16.0	30mm	32	26.0	22.0	32.5	44.6
CLA-22M	22	18.3	30mm	32	26.0	22.0	32.5	44.6
CLA-25M	25	22.0	1-3/8	38	31.3	26.5	36.8	49.1
CLA-28M	28	23.0	41mm	46	36.6	36.6	43.2	64.0
CLA-32M	32	28.0	46mm	50	42.0	41.6	49.3	72.3
CLA-38M	38	34.0	55mm	60	49.4	47.9	56.4	84.0
CLA-42M	42	36.0	55mm	65	55.1	53.6	58.0	89.1
CLA-50M	50	45.2	70mm	3 in.	65.0	61.0	69.0	106.0